

## FAQ

### Check Connection Status 1

- LAN port and cable -

## [FAQ – Check Connection Status ① / LAN port and cable]

### LED Indicator

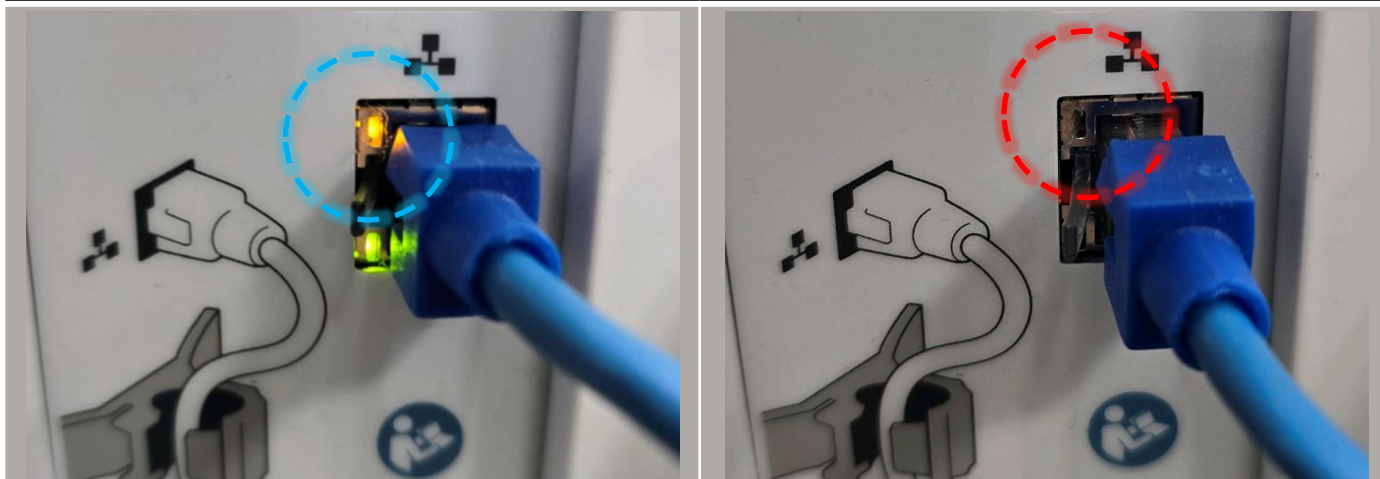

**ON → Normal**

**OFF → Abnormal**

- If the LED indicator is ON, it is functioning normally.
- If it is OFF, it indicates an issue.  
: Inspection or replacement of the cable or LAN port is required.

Link/Activity LED	
Status	Description
Off	Not connected
Yellow	LAN is properly connected
Blinking	Normal communication in progress

### Network port

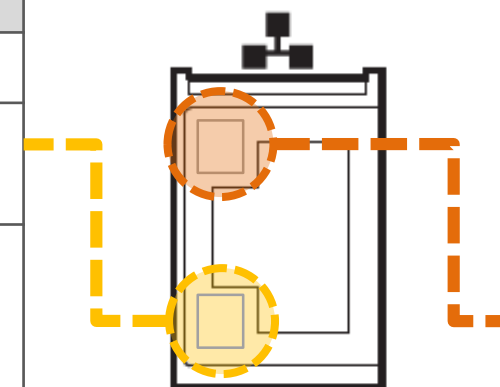

Speed LED	
Status	Description
Off	10 Mbps
Green	100/1000 Mbps
Orange	2.5 Gbps